

PROPRIETARY AND CONFIDENTIAL
 THE INFORMATION CONTAINED IN THIS DRAWING IS THE SOLE PROPERTY OF ARDENT CONCEPTS, INC. ANY REPRODUCTION IN PART OR AS A WHOLE WITHOUT THE WRITTEN PERMISSION OF ARDENT CONCEPTS, INC. IS PROHIBITED.

REVISIONS			
REV.	DESCRIPTION	DATE	APPROVED
NR	NOT RELEASED	5-29-12	BMS

D
C
B
A

D
C
B
A

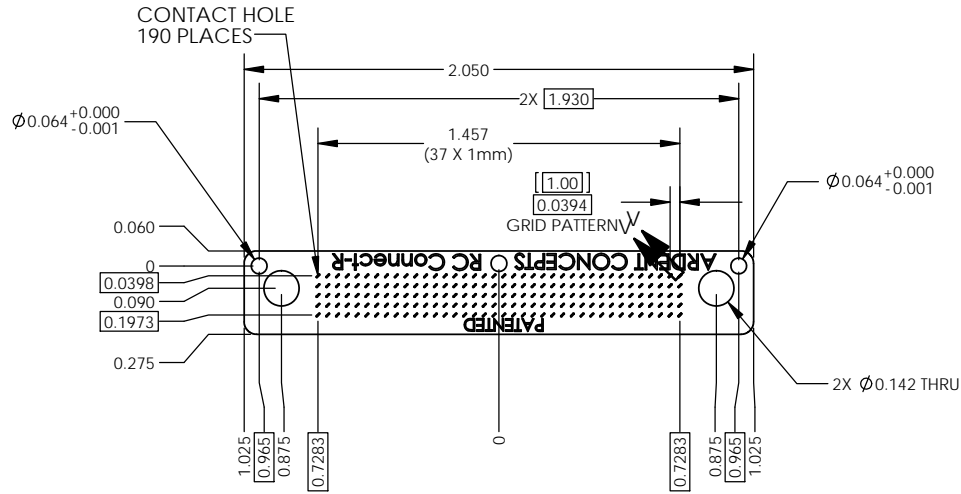

- NOTES:
- DRAWING CONFORMS TO ASME Y14.100
 - MATERIAL:
HOUSING: LIQUIP CRYSTAL POLYMER
CONTACT: BeCu ALLOY 190
 - CONTACT FINISH: 20 MICROINCHES MINIMUM ELECTROPLATED HARD GOLD (120 KNOOP MIN) OVER 50 MICROINCHES MINIMUM ELECTROPLATED NICKEL
 - TEMPERATUR RANGE -54 °C TO 120 °C
 - ELECTRICAL CHARACTERISTICS:
CONTACT RESISTANCE: <50 MILLIOHMS
CONTACT FORCE: < 50 GRAMS
INSERTION LOSS: <.5db AT 10 GHz
 - △6. TEXT TO BE SUB-FLUSH

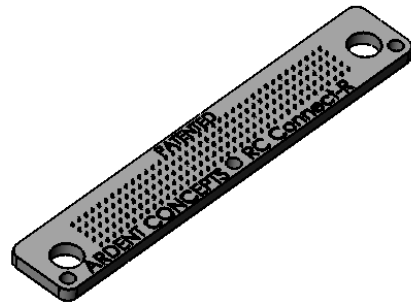
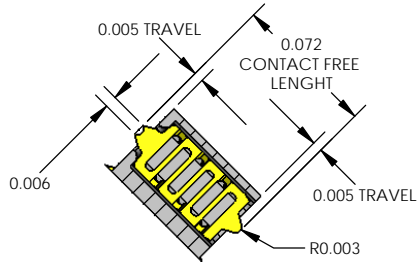

INCH UNLESS OTHERWISE SPECIFIED.	DRAWN	BMS	DATE	8-30-11	 130 LEDGE ROAD SEABROOK, NH 03874 603-474-1760
	TOLERANCES: ANGLES: ± 3	CHECKED	ENG APPR.		

CHANGE MATERIAL FINISH	NOTE SEE NOTES	PROJECTION	SIZE B	TITLE: 190 CONTACT INTERPOSER ASSEMBLY	INTERPRET GEOMETRIC TOLERANCING PER: ANSI Y14.100	DWG. NO. CA190CR1001	REV NR
WWW.ARDENTCONCEPTS.COM			SCALE: 2:1	WEIGHT:	SHEET 1 OF 1		